

# 25DU

## TANDEM DUAL GOOSENECK DUMP

<b>G.V.W.R.</b>	25,900#	<b>AXLES</b>	Two 10,000# Dual Wheel Oil Bath Electric Brake Axles
<b>G.A.W.R. (EA. AXLE)</b>	10,000#	<b>SUSPENSION</b>	Multi-Leaf Slipper Spring w/ Equalizer
<b>COUPLER</b>	2-5/16" Ball Adjustable Pipe	<b>TIRE</b>	LT235/85R16 Load Range E
<b>SAFETY CHAINS</b>	3/8" Grd. 70 w/Safety Latch Hook (2 ea.)	<b>WHEEL</b>	16 X 6 Dual 8 Bolt
<b>JACKS</b>	Two 10,000# Dropleg Jacks (Bolted On)	<b>FLOOR</b>	10 Gauge Smooth Steel
<b>NECK</b>	12" Channel	<b>LIGHTS</b>	D.O.T. Stop, Tail, Turn and Clearance
<b>FRAME</b>	12" X 16# I-Beam	<b>ELEC. PLUG</b>	6 Way
<b>FRAME CROSSMEMBERS</b>	7" Channel	<b>FINISH (PREP)</b>	Acid Etched w/White Phosphorus, Undercoated w/Panther 813 & Two Coats Primer
<b>BED CROSSMEMBERS</b>	3" Channel	<b>FINISH</b>	Painted w/ 2 Coats High Solid <i>Supreme</i> Acrylic Automotive Grade Enamel, and Pinstriped
<b>BED LONG SILS</b>	7" Channel		
<b>SIDE RAILS</b>	3" X 5" Angle		

### STANDARD FEATURES

- Complete Break-A-Way System w/ Charge Line
- Heavy Duty 10 Gauge Floor
- 48" Sides w/ Formed Channel Supports
- Spare Mount
- Self Contained Electric Hydraulic Scissor Lift
- Lockable Control Unit
- 45 Degree Dump Angle
- Double Rear Gates w/ Cam Latch
- Removable Header Across Rear
- Double 1/2" Tie Rods On All 4 Sides
- Fully Enclosed Pump & Battery Box Between Gooseneck Uprights

25DU-16

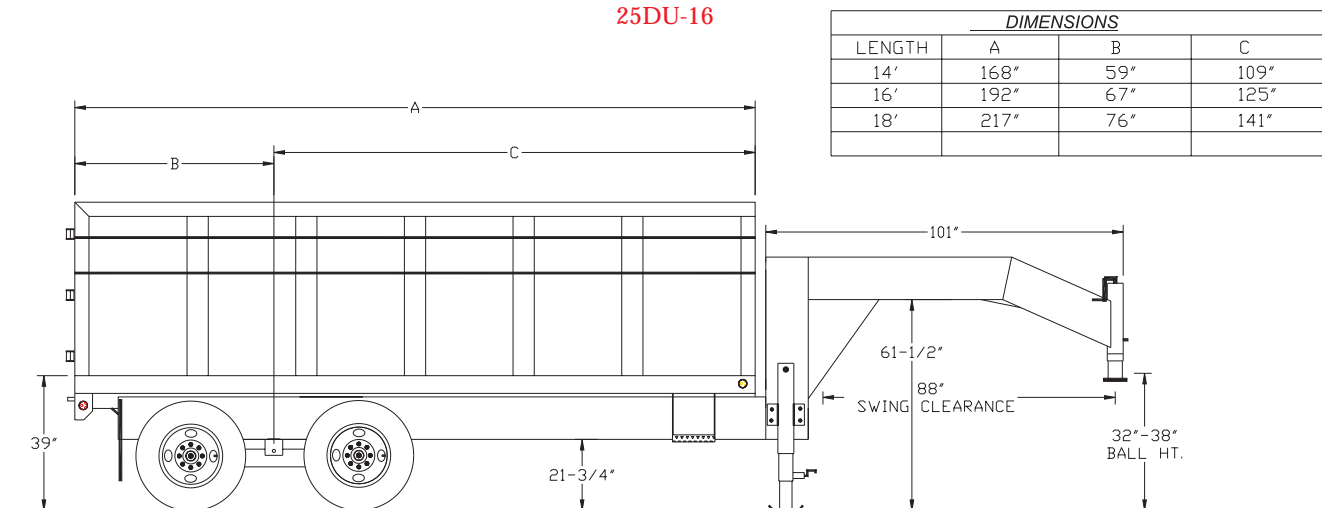

### TRAILER WEIGHTS & CAPACITIES

LENGTH	EMPTY WEIGHT	BOX CAPACITY
14'	6875#	16.3 Yards
16'	7,140#	18.7 Yards
18'	7500#	21.0 Yards

### OPTIONS

<b>D2SPJ</b>	Dual 2-Speed Landing Gear Jack (150K)
<b>SP16"</b>	Spare Tire & Wheel - Load Range E
<b>RS</b>	Removable Sides
<b>NS</b>	No Sides w/ Stake Pockets & Rubrail (Flatbed)

Effective January 1, 2003 (Specifications and Options subject to change without notice.)